

SINGLE-PLY: TPO & PVC

ANSI/SPRI/FM4435/ES-1 TEST PRESSURES UP TO 381 PSF (HORIZONTAL)

METAL TYPE	MAXIMUM FRONT FACE HEIGHT (in.)	PERIMETER PRESSURE (psf)		CORNER PRESSURE (psf)	
		HORIZONTAL	VERTICAL	HORIZONTAL	VERTICAL
0.040" ALUMINUM	5.25	320	N/A	325	N/A
0.040" ALUMINUM	6	204	N/A	200	N/A
0.040" ALUMINUM	10	102	N/A	109	N/A
24 GA. STEEL	5.25	378	N/A	379	N/A
24 GA. STEEL	6	247	N/A	236	N/A
24 GA. STEEL	10	131	N/A	127	N/A
0.039" ZINC	6	189	N/A	182	N/A
0.039" ZINC	10	131	N/A	127	N/A

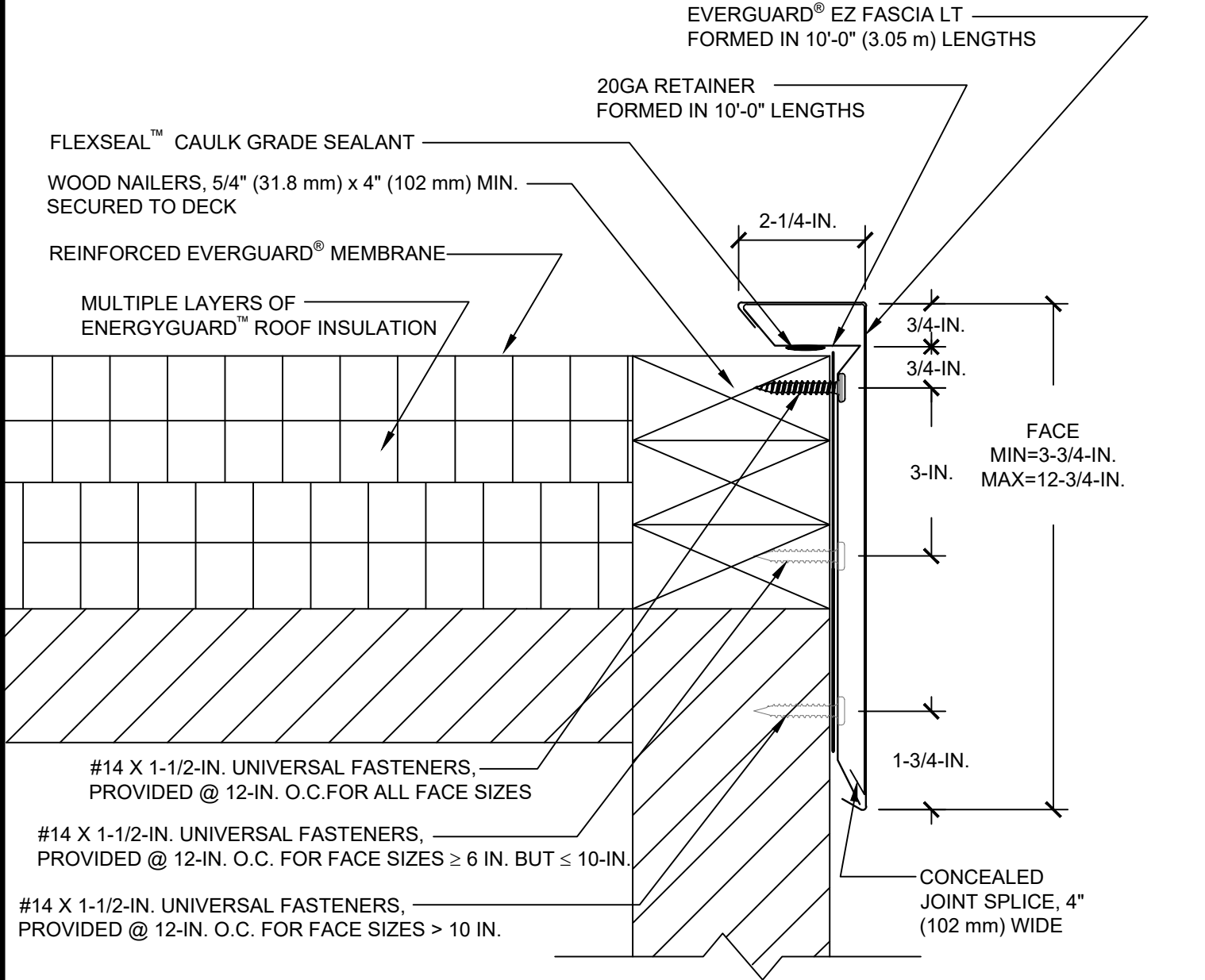

NOTE:

1. PRODUCT TO BE INSTALLED IN STRICT ACCORDANCE WITH GAF PRINTED INSTRUCTIONS.
2. PRE-DRILL WITH 3/16-IN. DRILL BIT FOR MASONRY CONDITIONS.
3. CONTACT GAF FOR APPROPRIATE RECOMMENDATIONS NEEDED TO MEET/EXCEED ANSI/SPRI/FM4435/ES-1 DESIGN CRITERIA.



EZ FASCIA

DRAWING #
232A

THIS DETAIL APPLIES TO:	ISSUE / REVISION DATE	SCALE
ALL SYSTEMS	8/17/20	N.T.S.

LEGEND