

SINGLE-PLY: TPO

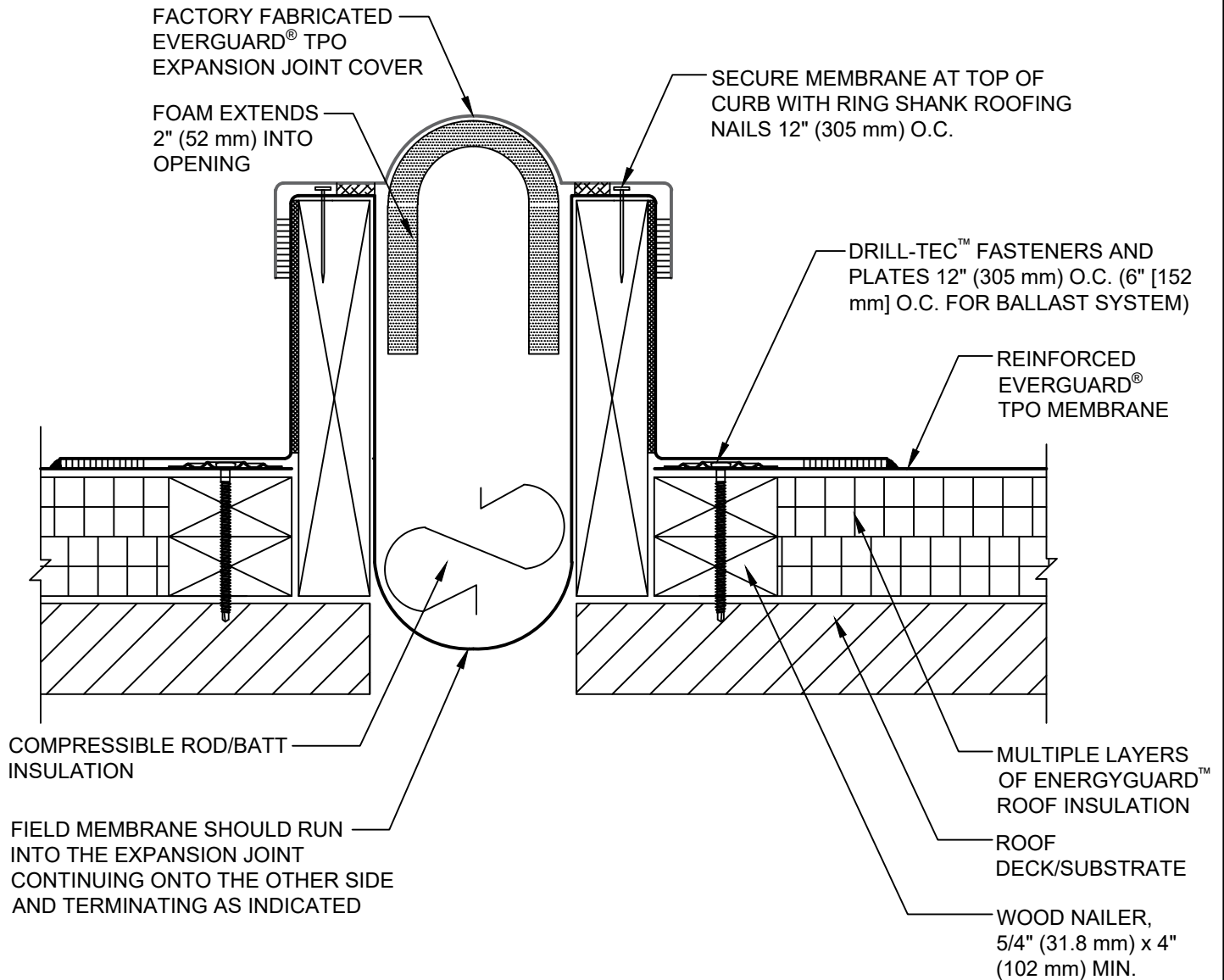

NOTE:

1. FOR INSULATION THICKNESS GREATER THAN 8" (203 mm), A COVER BOARD IS REQUIRED ON MECHANICALLY ATTACHED SYSTEMS ONLY.



TPO FACTORY FABRICATED EXPANSION JOINT DETAIL - CURB TYPE



DRAWING #
402A

THIS DETAIL APPLIES TO:
ALL SYSTEMS

ISSUE / REVISION DATE
8/17/20

SCALE
N.T.S.

LEGEND

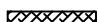
-  HEAT-WELDED
-  EVERGUARD® BONDING ADHESIVE (OPTIONAL)
-  TACK WELD INTERMITTENTLY ON BOTH CURBS TO HOLD IN PLACE IF NEEDED