

SINGLE-PLY: TPO

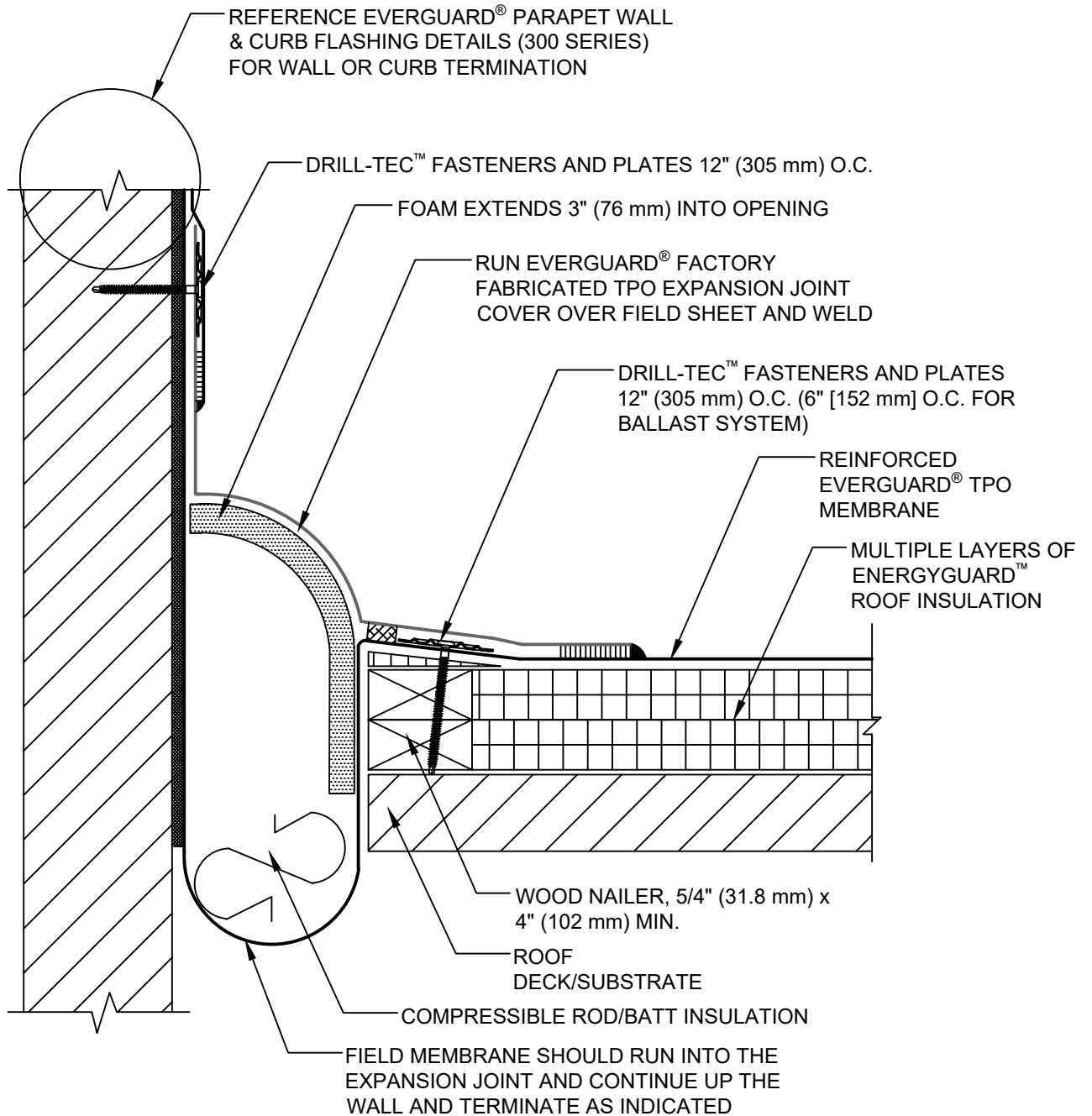

NOTE:

1. FOR INSULATION THICKNESS GREATER THAN 8" (203 mm), A COVER BOARD IS REQUIRED ON MECHANICALLY ATTACHED SYSTEMS ONLY.
2. HEAT-WELD EXPANSION JOINT FLANGE TO WALL FLASHING ADJACENT TO BELLOWS TO HOLD PROPER ELEVATION.



FACTORY FABRICATED WALL EXPANSION JOINT - FLAT TYPE

DRAWING #
403A

THIS DETAIL APPLIES TO:
ALL SYSTEMS

ISSUE / REVISION DATE
8/17/20

SCALE
N.T.S.

LEGEND

- HEAT-WELDED
- EVERGUARD® BONDING ADHESIVE
OPTIONAL UP TO 30" (762 mm) FLASHING HEIGHT
- TACK WELD INTERMITTENTLY ON BOTH CURBS TO HOLD IN PLACE IF NEEDED