

# SINGLE-PLY: TPO

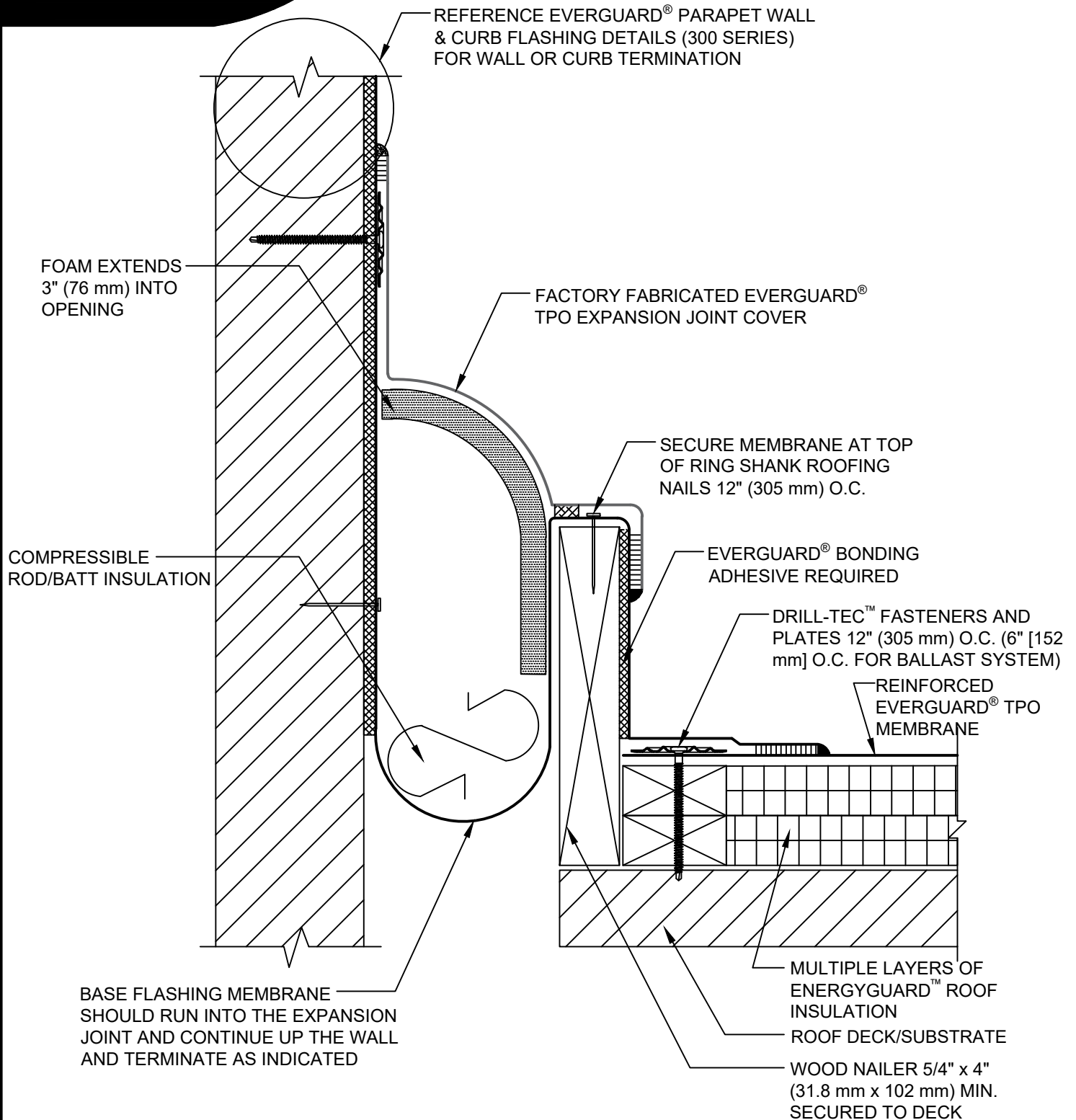

**NOTE:**

1. FOR INSULATION THICKNESS GREATER THAN 8" (203 mm), A COVER BOARD IS REQUIRED ON MECHANICALLY ATTACHED SYSTEMS ONLY.



## TPO FACTORY FABRICATED WALL EXPANSION JOINT - CURB TYPE

DRAWING #  
**404A**

THIS DETAIL APPLIES TO:  
ALL SYSTEMS

ISSUE / REVISION DATE  
8/17/20

SCALE  
N.T.S.

**LEGEND**

	HEAT-WELDED
	EVERGUARD® BONDING ADHESIVE -OPTIONAL UP TO 30" (762 mm) FLASHING HEIGHT
	TACK WELD FLANGE INTERMITTENTLY BETWEEN FASTENERS ADJACENT TO BELLOWS