

ASPHALTIC

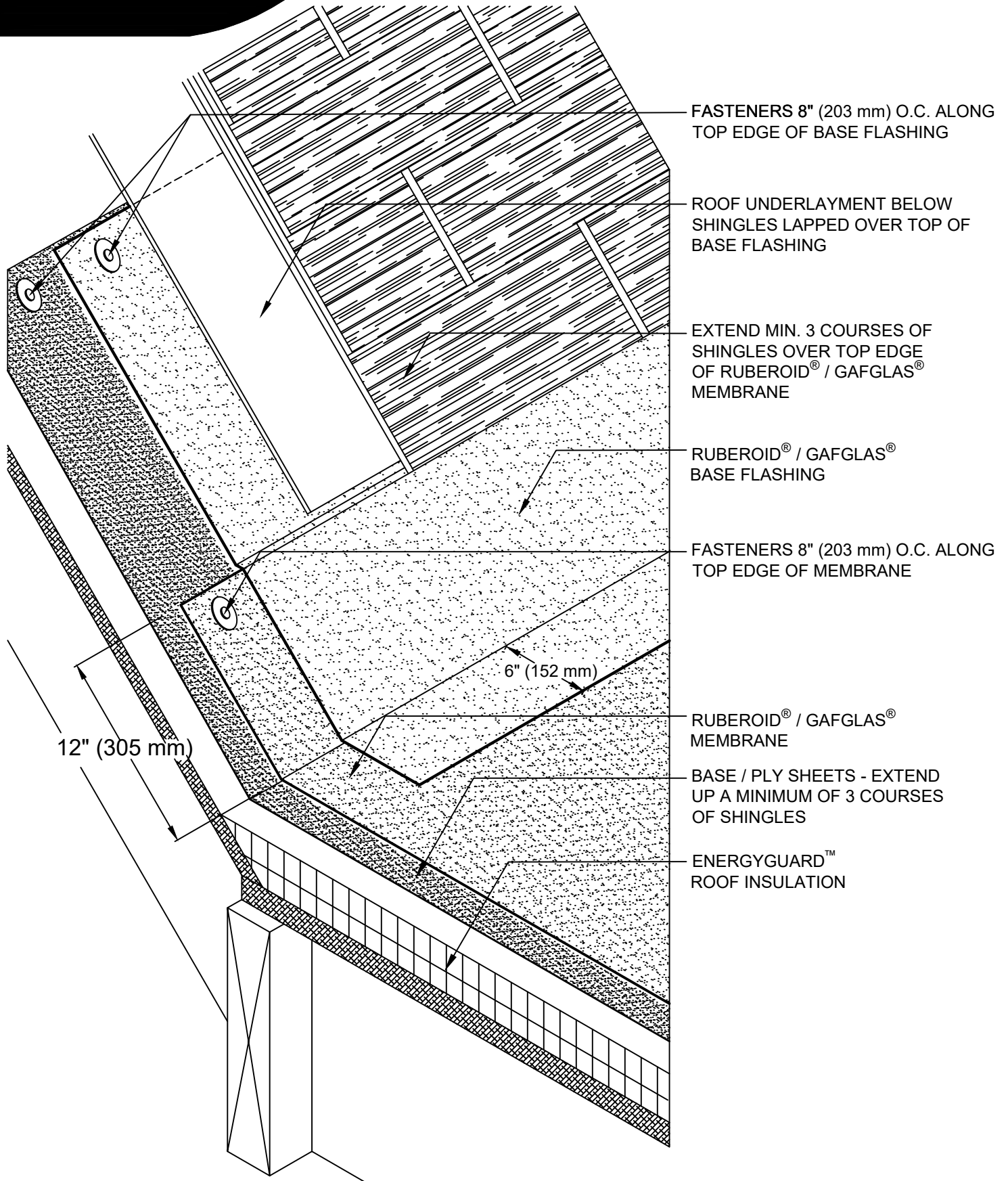

FASTENERS 8" (203 mm) O.C. ALONG TOP EDGE OF BASE FLASHING

ROOF UNDERLAYMENT BELOW SHINGLES LAPPED OVER TOP OF BASE FLASHING

EXTEND MIN. 3 COURSES OF SHINGLES OVER TOP EDGE OF RUBEROID® / GAFGLAS® MEMBRANE

RUBEROID® / GAFGLAS® BASE FLASHING

FASTENERS 8" (203 mm) O.C. ALONG TOP EDGE OF MEMBRANE

6" (152 mm)

RUBEROID® / GAFGLAS® MEMBRANE

BASE / PLY SHEETS - EXTEND UP A MINIMUM OF 3 COURSES OF SHINGLES

ENERGYGUARD™ ROOF INSULATION

12" (305 mm)

STEEP-SLOPE SHINGLE TO LOW-SLOPE ROOF TIE-IN DETAIL

LEGEND



DRAWING #  
**601**

ISSUE / REVISION DATE

2/20/20

SCALE

N.T.S.